

KEY MAP

DATE	NAME	No
JAN 1, 1987	GEORGE A SNIFFIN	20981
JAN 1, 1993	PATRICK H FATTON	35361
JAN 1, 1994	PATRICK H FATTON	35361
JAN 1, 1995	PATRICK H FATTON	35361
JAN 1, 1996	PATRICK H FATTON	35361
JAN 1, 1997	PATRICK H FATTON	35361
JAN 1, 1998	VERNON PLAWSON	34864
JAN 1, 1999	BRUCE R. BLAIR	15098
JAN 1, 2000	BRUCE R. BLAIR	15098
JAN 1, 2014	PATRICK H FATTON	35361
JAN 1, 2016	PATRICK H FATTON	35361
JULY 2017	PAMELA L. MATTHEWS	41181

Thomas L. Yager & Associates
16 Gray Road, Roseland, New Jersey 07068
THOMAS L. YAGER, N.J.S. 26790
REVISED 15FEB06
REVISED 03 JAN 07
REVISED 02 JAN 08
REVISED 02 JAN 09
REVISED 04 JAN 10
REVISED 04 JAN 11
REVISED 03 JAN 12

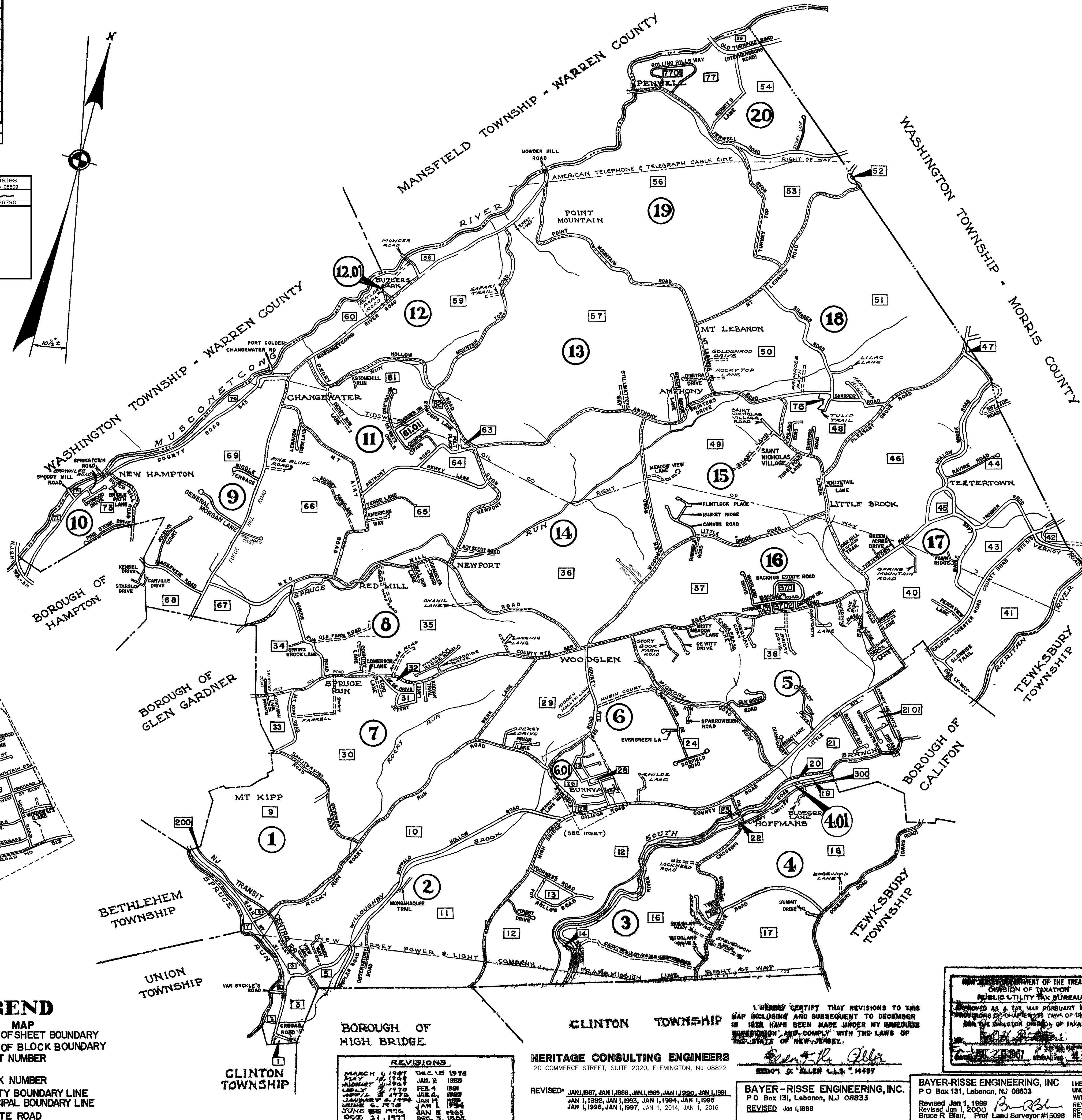
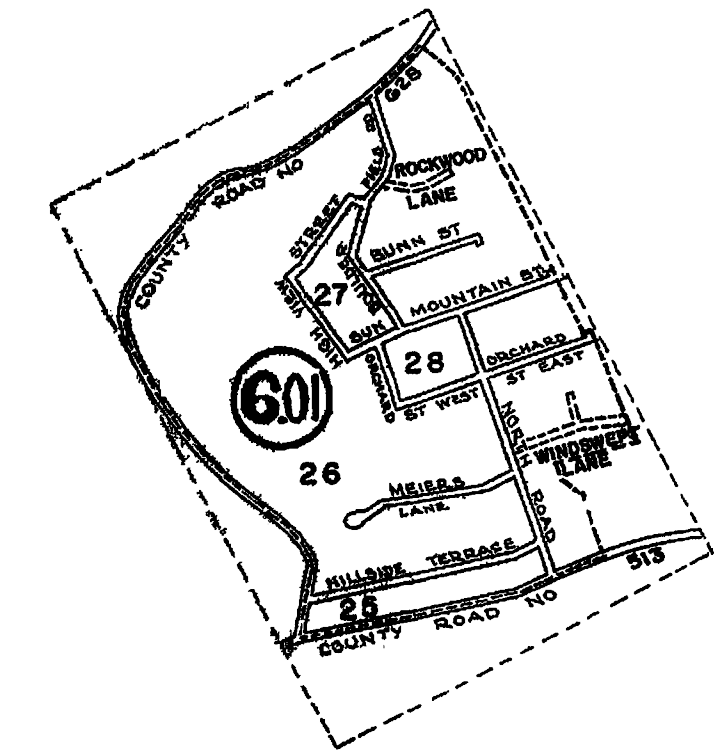
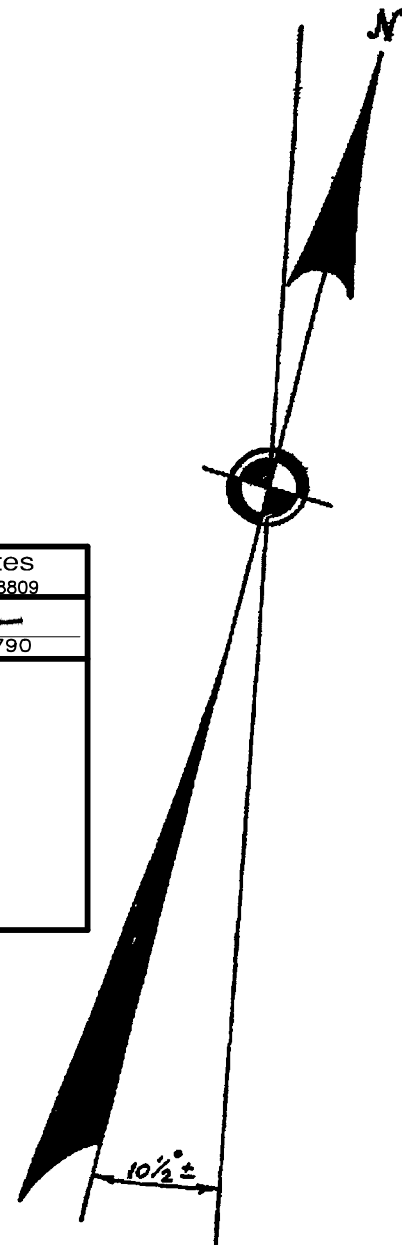

I HEREBY CERTIFY THAT THIS MAP HAS BEEN REVISED UNDER MY IMMEDIATE SUPERVISION, AND COMPLIES WITH THE LAWS OF THE STATE OF NEW JERSEY.

PAMELA L. MATTHEWS, PROFESSIONAL LAND SURVEYOR DATE
NEW JERSEY LIC. NO. 41181
VAN CLEEF ENGINEERING ASSOCIATES
32 BROWER LANE
HILLSBOROUGH, N.J. 08844

NOTE:
THE AREAS, BOUNDARIES AND DIMENSIONS SHOWN ON THIS TAX MAP ARE DERIVED FROM GROUND SURVEYS, AERIAL SURVEYS, AND RECORDED PLANS, MAPS, DEEDS, AND WILLS AND ARE TO BE USED FOR ASSESSMENT PURPOSES ONLY.

CERTIFICATE:
I HEREBY CERTIFY THAT THIS MAP HAS BEEN REVISED AND UPDATED UNDER MY IMMEDIATE SUPERVISION, AND COMPLIES WITH THE LAWS OF THE STATE OF NEW JERSEY.

ROBERT McALDOWNEY, JR.
PROFESSIONAL ENGINEER & LAND SURVEYOR
NEW JERSEY LICENSE NO. 7699
LEBANON TOWNSHIP ENGINEER



LEGEND

KEY MAP

- LINE OF SHEET BOUNDARY
- LINE OF BLOCK BOUNDARY
- ④ SHEET NUMBER
- ⑫ BLOCK NUMBER
- COUNTY BOUNDARY LINE
- MUNICIPAL BOUNDARY LINE
- PRIVATE ROAD

REVISIONS

MARCH 1, 1987	DEC 15, 1978
MAY 1, 1988	JAN 2, 1989
JAN 1, 1993	FEB 4, 1994
JAN 1, 1994	JAN 1, 1995
JAN 1, 1996	JAN 1, 1997
JAN 1, 1998	JAN 1, 1999
JAN 1, 2000	JAN 1, 2014
JAN 1, 2016	JAN 1, 2016
DEC 31, 1977	DEC 5, 1983

HERITAGE CONSULTING ENGINEERS
20 COMMERCE STREET, SUITE 2020, FLEMINGTON, NJ 08822

REVISED: JAN 1, 1987, JAN 1, 1988, JAN 1, 1989, JAN 1, 1990, JAN 1, 1991, JAN 1, 1992, JAN 1, 1993, JAN 1, 1994, JAN 1, 1995, JAN 1, 1996, JAN 1, 1997, JAN 1, 2014, JAN 1, 2016

I HEREBY CERTIFY THAT REVISIONS TO THIS MAP INCLUDING AND SUBSEQUENT TO DECEMBER 31, 1986 HAVE BEEN MADE UNDER MY IMMEDIATE SUPERVISION AND COMPLIES WITH THE LAWS OF THE STATE OF NEW JERSEY.

BRUCE R. BLAIR
BRUCE R. BLAIR, N.J.S. 14487

BAYER-RISSE ENGINEERING, INC.
P O Box 131, Lebanon, NJ 08833
REVISED Jan 1, 1988

BAYER-RISSE ENGINEERING, INC.
P O Box 131, Lebanon, NJ 08833
REVISED Jan 1, 1989
REVISED Jan 1, 2000
Bruce R. Blair, Prof Land Surveyor #15098

I HEREBY CERTIFY THAT THIS MAP HAS BEEN REVISED UNDER MY IMMEDIATE SUPERVISION AND COMPLIES WITH THE STATE OF NEW JERSEY
REVISED JAN 1, 2001
REVISED JAN 1, 2002
REVISED JAN 1, 2003

TAX MAP
of
LEBANON TOWNSHIP
in
HUNTERDON COUNTY, NEW JERSEY
prepared by
JOHN E. STUDER & PEELS
Studer & McEwen, Inc. PA
Civil Engineers & Land Surveyors
120 Highway 24 Clinton New Jersey

SCALE 1"=2000 DATE MAY 1987